

Mounting Hardware

RM-SWC2001/RM-SWC2002

<User Guide>
Ver.1.0.0

- Thank you for choosing our product.
- To ensure the best performance of this product, please read this user guide fully and carefully before using it and keep this manual together with the product for future reference as needed.

Before reading this manual

- All rights reserved.
- Some information contained in this User guide such as exact product appearance, diagrams, menu operations, communication commands, and so on may differ depending on the product version.
- This User guide is subject to change without notice. You can download the latest version from IDK's website at: <http://www.idkav.com>

Included items

Verify that all items listed below are included in the package.
If any items are missing or damaged, please contact IDK.

RM-SWC2001	
Mounting bracket (701A05)	1
Single plate (701A06)	1
M3 screws (Binding head, M3xL6)	4

RM-SWC2002	
Connecting bracket (701A04)	1
Mounting bracket (701A05)	2
M3 screws (Binding head, M3xL6)	8

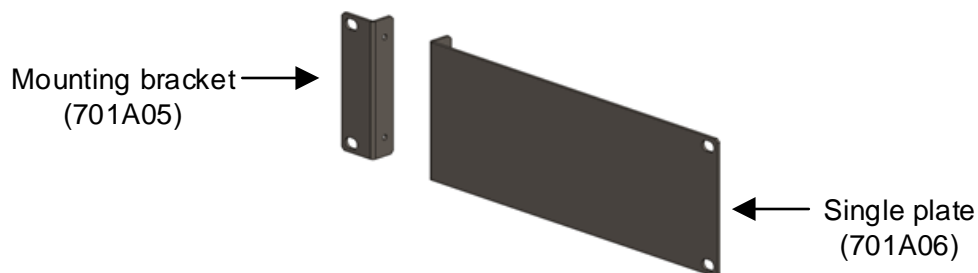

[Fig. 1] Included Items for RM-SWC2001

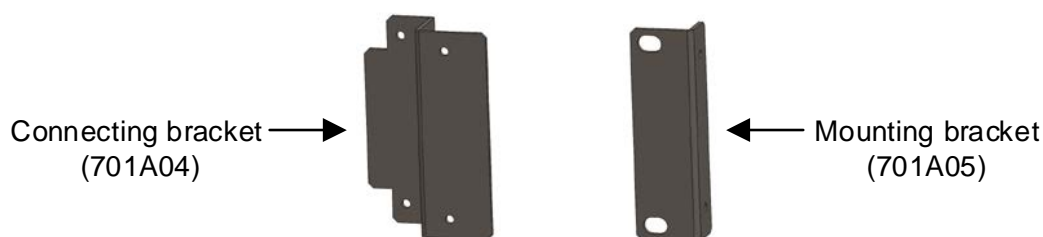

[Fig. 2] Included Items for RM-SWC2002

Precaution

Please observe the following precautions.

- Power off all devices before installation.
- Remove the rubber feet from the bottom of the chassis, if any.
- Dissipate static electricity before installation. Failure to observe this precaution may result in ESD (electrostatic discharge) damage.
- The appropriate screw tightening torque: M3: 0.59 N·m (6.1 kgf·cm, approx.)

RM-SWC2001 (701A05 and 701A06)

The RM-SWC2001 is for mounting an SWC-2000 on an EIA rack.

1. Remove the bracket as shown below from the bottom of the SWC-2000.

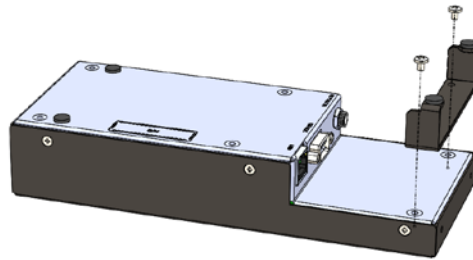

[Fig. 3] Removing bracket

2. Attach the mounting bracket (701A05) and single plate (701A06) to the SWC-2000 using the supplied M3 screws.

In Fig. 4, the mounting bracket (701A05) and single plate (701A06) are attached to left and right sides respectively, but these brackets can be placed reversely.

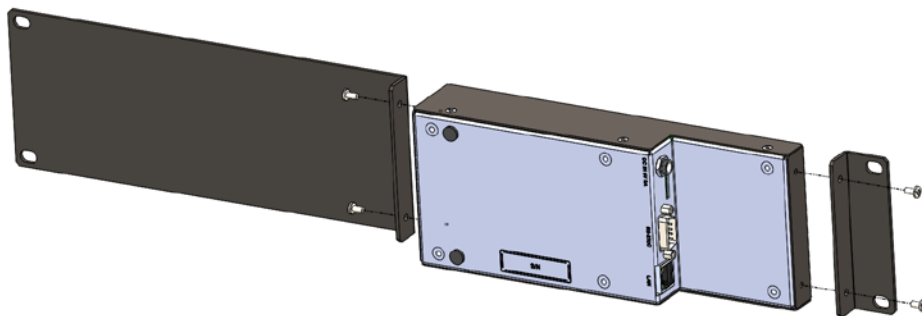

[Fig. 4] Attaching 701A05 and 701A06

RM-SWC2002 (701A04 and 701A05)

The RM-SWC2002 is for mounting two (2) SWC-2000s on an EIA rack.

1. Remove the bracket as shown below from the bottom of the SWC-2000.

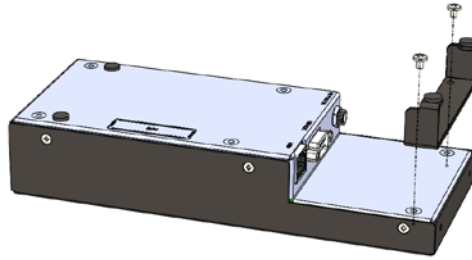

[Fig. 5] Removing bracket

2. Attach the connecting bracket (701A04) and two (2) mounting brackets (701A05) to connect two (2) SWC-2000s using the supplied M3 screws.

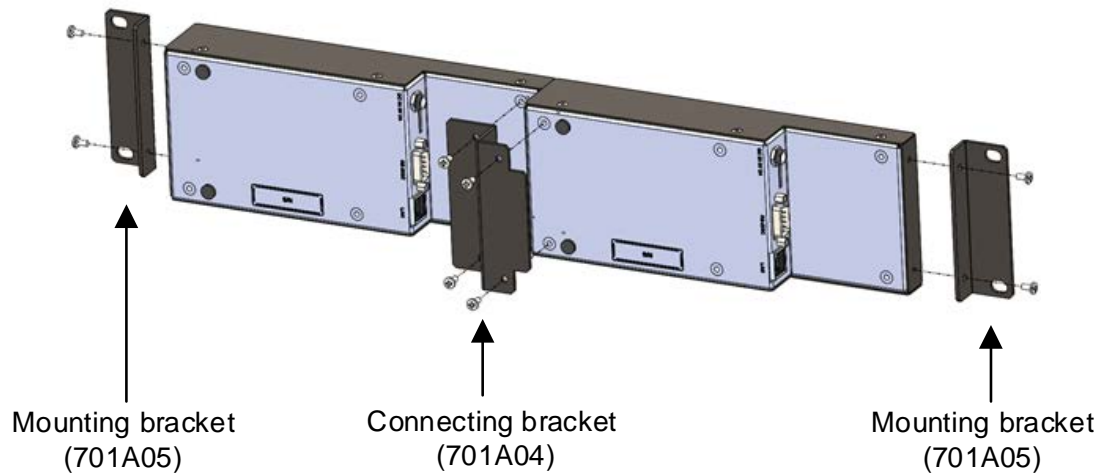

[Fig. 6] Attaching 701A04 and 701A05

User Guide of RM-SWC2001/RM-SWC2002
Ver.1.0.0
Issued on: 12 July 2019



Headquarters IDK Corporation
7-9-1 Chuo, Yamato-shi, Kanagawa-pref.
242-0021 JAPAN
TEL: +81-46-200-0764 FAX: +81-46-200-0765
Email: idk_eng@idk.co.jp URL: <http://www.idkav.com>

USA IDK America Inc.
72 Grays Bridge Road Suite 1-C, Brookfield, CT 06804
TEL: +1-203-204-2445
Email: sales@idkav.com URL: <http://www.idkav.com>

Europe IDK Europe GmbH
Lise-Meitner-Str. 6, D-40878 Ratingen
TEL: +49-2102-578-301-0
Email: info@idkav.eu URL: <http://www.idkav.com>



**Product information
Support** Arvanics Corporation
7-9-1 Chuo, Yamato-shi, Kanagawa-pref.
242-0021 JAPAN
TEL: +81-46-259-6920 FAX: +81-46-259-6930
Email: info@arvanics.com URL: <http://www.arvanics.com>

Information in this document is subject to change without notice.
©2019 IDK Corporation, all rights reserved. All trademarks mentioned are the property of their respective owners.