



The IDK GF-100 is a handy video analyzer for HDMI/DVI devices. The GF-100 can be used for testing source/sink devices, monitoring DDC between source and sink devices, testing signal transmission, and so on.

■ Specification

Source test / cable test / transmission test

Item			Description
Video	HDMI / DVI	Number / Signal	1 input / HDMI Deep Color (*1) / DVI 1.0 / HDCP 1.4 - TMDS single link - TMDS clock: 25 MHz to 225 MHz - Dot clock 25 MHz to 165 MHz
		Connector	1 female HDMI Type A
Audio	Digital Audio	Number / Signal	1 input / Multi-channel LPCM up to 8 channels - Sampling frequency: 32 kHz to 192 kHz - Sample size: 16 bit to 24 bit - Reference level:-20 dBFS - Max. input level: 0 dBFS
		Connector	1 female HDMI Type A
Functions			Video status display - Resolution / Frame rate / Aspect Ratio / HDMI signal status / DVI signal status / HDCP status / Color space / color depth / DDC voltage status / Video timing / Dot clock frequency / Info frame information / etc... Audio status display - Audio format / number of audio channel / sampling frequency / sample size / speaker position / Info frame information / etc... EDID emulation (with copy function) Comparing transmitted signal and received signal by test signal Source status is output to terminal software Status log display and confirmation by web browser

Sink test / cable test / transmission test

Item			Description
Video	HDMI / DVI	Number / Signal	1 output / HDMI Deep Color (*1) / DVI 1.0 / HDCP 1.4 - TMDS single link - TMDS clock: 25 MHz to 225 MHz - Dot clock 25 MHz to 165 MHz
		Connector	1 female HDMI Type A
		Test pattern output Format	Color space: RGB 4:4:4 / YCbCr 4:2:2 / YCbCr 4:4:4 Color Depth: 24 bit, 30 bit, 36 bit Deep Color Resolution: 480i / 480p / 576i / 576p / 720p / 1080i / 1080p VGA / SVGA / XGA / WXGA (1280x768) / WXGA (1280x800) / Quad-VGA / SXGA / WXGA (1360x768) / WXGA (1366x768) / SXGA+ / WXGA+ / WXGA++ / UXGA / WSXGA+ / WUXGA / QWXGA *WUXGA/QWXGA are output as Reduced Blanking
Audio	Digital Audio	Number / Signal	1 output / Multi-channel LPCM up to 8 channels - Sampling frequency: 32 kHz to 192 kHz - Sample size: 16 bit to 24 bit - Reference level:-20 dBFS - Max. input level: 0 dBFS
		Connector	1 female HDMI Type A
		Test tone output Format	1 output / Multi-channel linear PCM up to 8 channels - Sampling frequency: 48 kHz - Sample size: 24 bit - Reference level:-20 dBFS - Max. input level: 0 dBFS
Functions			Sink device specification display - Supported resolution / HDMI signal support or not / HDCP support or not / Color space / color depth / speaker position / EDID information / etc... Test pattern output - Color bar / gray scale / crosshatch / stripe / raster / etc... Test tone output - Test audio / speaker test by each audio channel (1000 Hz / 400 Hz / 80 Hz / 40 Hz) Comparing transmitted signal and received signal by test signal Status display by web browser / EDID information download

DDC Monitoring

Item		Description
Operation		Pass through
Connector		2 female HDMI Type A
Functions		DDC communication check and display between source device and sink device - Hot Plug voltage / DDC voltage / EDID / HDCP Communication log is output to terminal software Communication log display and confirmation by web browser

LAN

Item		Description
LAN	Number / Signal	1 port / 10Base-T (Auto Negotiation), 100Base-TX (Auto Negotiation), Auto MDI/MDI-X
	Connector	1 RJ-45

● All specifications and drawings are subject to change without notice. ● Please do not use the supplied AC adapter and power supply cable for other products. ● The GF-100 is a portable analyzer only for AV system field support. ● The terms HDMI and HDMI High-Definition Multimedia Interface, and the HDMI Logo are trademarks or registered trademarks of HDMI Licensing Administrator, Inc. in the United States and other countries. ● PJLink is a trademark in Japan, the United States, and other countries/regions. ● HDBaseT™ and the HDBaseT Alliance Logo are trademarks of the HDBaseT Alliance. ● The terms Anti-snow and Connection Reset are registered trademarks of IDK Corporation in Japan. ● All other company and product names mentioned in this document are either registered trademarks or trademarks of their respective owners. In this document, the "®" or "™" marks may not be specified.

Others

Item	Description
AC adapter	Input: 100 - 240 VAC ± 10%, 50 Hz / 60 Hz ± 3 Hz Output: DC 12V 3A (AC adapter supplied)
Power consumption	About 11 Watts
Dimensions	10.2 x 2.1 x 5.2" (260(W) x 53.5(H) x 133(D) mm)
Weight	2 lbs. (0.9 kg)
Temperature	Operating: 32°F to 104°F (0°C to +40°C) Storage: -4°F to +176°F (-20°C to +80°C)
Humidity	Operating/Storage: 20% to 90% (Non Condensing)

*This product supports 36 bits/pixel Deep color (12 bit/component). It does not support x.v.Color, 3D, ARC, HEC and CEC.

■ Front & Rear Panel

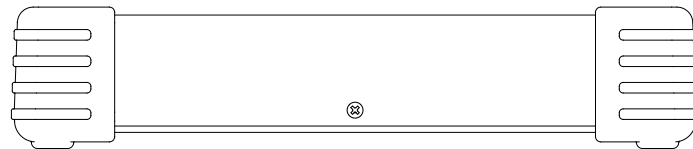
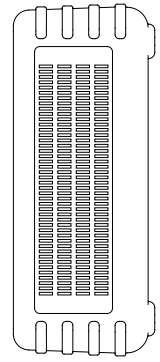
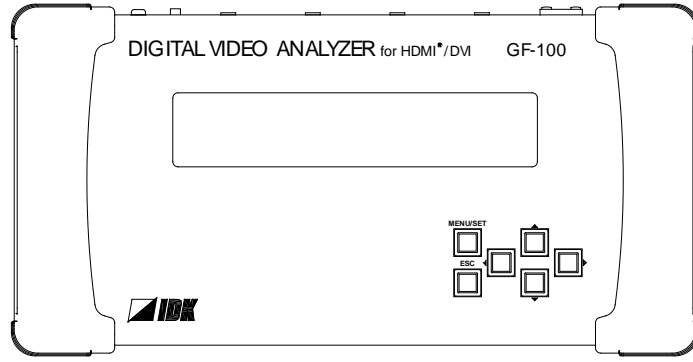
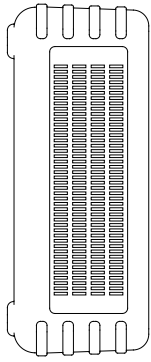
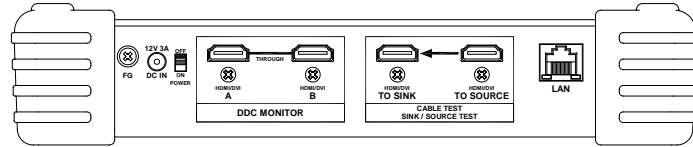

● All specifications and drawings are subject to change without notice. ● Please do not use the supplied AC adapter and power supply cable for other products. ● The GF-100 is a portable analyzer only for AV system field support. ● The terms HDMI and HDMI High-Definition Multimedia Interface, and the HDMI Logo are trademarks or registered trademarks of HDMI Licensing Administrator, Inc. in the United States and other countries. ● PJLink is a trademark in Japan, the United States, and other countries/regions. ● HDBaseT™ and the HDBaseT Alliance Logo are trademarks of the HDBaseT Alliance. ● The terms Anti-snow and Connection Reset are registered trademarks of IDK Corporation in Japan. ● All other company and product names mentioned in this document are either registered trademarks or trademarks of their respective owners. In this document, the "®" or "™" marks may not be specified.



GF-100 Diagram and Features

■ Diagram

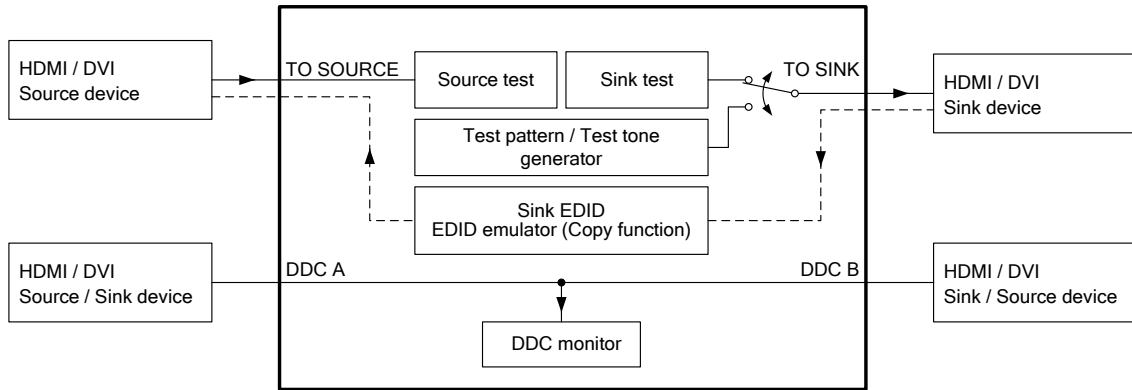

■ Sample connection diagram

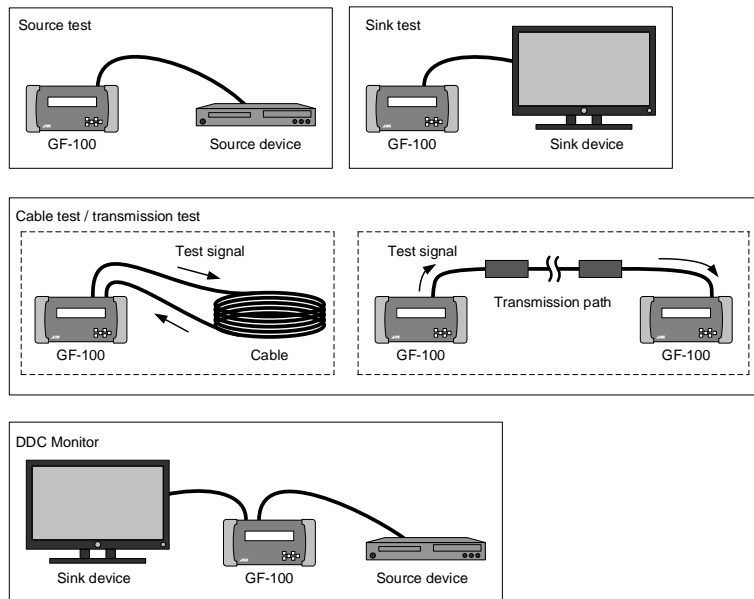

[Features]

■ Testing source devices

- Video status display
 - Resolution / Frame rate / Aspect Ratio / HDMI signal status / DVI signal status / HDCP status / Color space / color depth / DDC voltage status / Video timing / Dot clock frequency / Info frame information / etc...
- Audio status display
 - Audio format / number of audio channel / sampling frequency / sample size / speaker position / Info frame information / etc...
- EDID emulation (with copy function)
- Comparing transmitted signal and received signal by test signal
- Source status is output to terminal software
- Status log display and confirmation by web browser

■ Testing sink devices (Monitor)

- Sink device specification display
 - Supported resolution / HDMI signal support or not / HDCP support or not / Color space / color depth / speaker position / EDID information / etc...
- Test pattern output
 - Color bar / gray scale / crosshatch / stripe / raster / etc...
- Test tone output
 - Test audio / speaker test by each audio channel (1000 Hz / 400 Hz / 80 Hz / 40 Hz)
- Comparing transmitted signal and received signal by test signal
- Status display by web browser / EDID information download

■ Monitoring DDC

- DDC communication check and display between source device and sink device
 - Hot Plug voltage / DDC voltage / EDID / HDCP
- Communication log is output to terminal software
- Communication log display and confirmation by web browser

■ Transmission test (Cable)

- Comparing transmitted signal and received signal by test signal

● All specifications and drawings are subject to change without notice. ● Please do not use the supplied AC adapter and power supply cable for other products. ● The GF-100 is a portable analyzer only for AV system field support. ● The terms HDMI and HDMI High-Definition Multimedia Interface, and the HDMI Logo are trademarks or registered trademarks of HDMI Licensing Administrator, Inc. in the United States and other countries. ● PJLink is a trademark in Japan, the United States, and other countries/regions. ● HDBaseT™ and the HDBaseT Alliance Logo are trademarks of the HDBaseT Alliance. ● The terms Anti-snow and Connection Reset are registered trademarks of IDK Corporation in Japan. ● All other company and product names mentioned in this document are either registered trademarks or trademarks of their respective owners. In this document, the "®" or "™" marks may not be specified.